

## 14 Ashfield Mews, Wallsend



### Guide price £80,000 to £90,000

\*\*\*GUIDE PRICE £80,000 TO £90,000 \*\*\* We offer for sale with NO ONWARD CHAIN this SPACIOUS ground floor apartment situated on Ashfield Mews in Wallsend. The home is presented to a good standard and offers READY TO MOVE INTO into accommodation that may appeal to the FIRST TIME BUYER or someone who may be looking to DOWNSIZE. There are an excellent range of amenities to be found in the nearby town centre as well as road links to The Coast and Newcastle City Centre.

The property also benefits from a SECURE ENTRY SYSTEM, ALLOCATED PARKING and has access to COMMUNAL GARDENS. Council tax band A and energy rating B.

To arrange a viewing please call Next2buy on 0191 2953322.

## The Property Comprises

### Communal Entrance

Entrance door with secure entry system.

### Entrance Hallway

Entrance door, gas central heating radiator.

### Lounge

14'1" x 14'9" (4.28m x 4.49m) Upvc double glazed window, gas central heating radiator.



### Kitchen

8'7" x 6'8" (2.61m x 2.02m) Upvc double glazed window, gas central heating radiator, a range of fitted wall and floor units with complimenting work surfaces over, fitted electric oven and hob with extractor hood over, sink unit, integrated washing machine, dish washer and fridge freezer.



**Bedroom 1**

10'0" x 12'9" (3.06m x 3.89m) Upvc double glazed window, gas central heating radiator, fitted wardrobes.



**Bedroom 2**

9'2" x 7'9" (2.80m x 2.35m) Upvc double glazed window, gas central heating radiator.



**Bathroom**

8'0" x 6'6" (2.45m x 1.97m) Upvc double glazed window, gas central heating radiator, toilet, wash hand basin, bath with shower over, part tiled walls and tiled flooring.



**External**

Externally there is an allocated parking space and access to communal gardens.

**FLOOR PLANS**

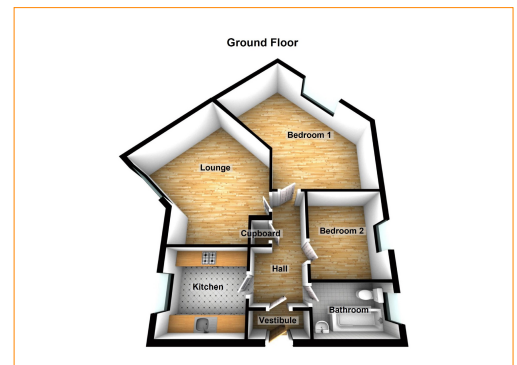

These plans are intended as a guide only, they are NOT TO SCALE. They are provided to give an overall impression of room layout and should not be taken as being scaled drawings.

**ENERGY EFFICIENCY AND ENVIRONMENTAL IMPACT**

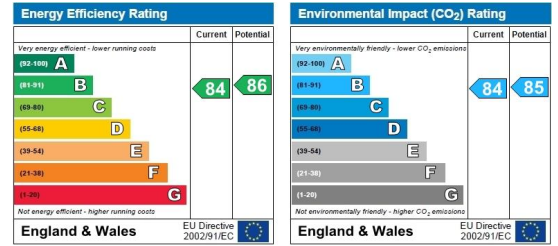

**VIEWING ARRANGEMENTS**

To arrange a viewing, please call 0191 2953322 or e-mail us; info@next2buy.com

Open Hours;  
 Monday 9am - 6pm  
 Tuesday 9am - 6pm  
 Wednesday 9am - 6pm  
 Thursday 9am - 6pm  
 Friday 9am - 6pm  
 Saturday 9am - 6pm

N/B The mention of any appliances and/or services within these particulars does not imply that they are in full and efficient working order.

**VIEWING APPOINTMENT**

TIME .....

DAY/DATE .....

VENDORS NAME (S) .....

**QR CODE**



You may download, store and use the material for your own personal use and research. You may not republish, retransmit, redistribute or otherwise make the material available to any party or make the same available on any website, online service or bulletin board of your own or of any other party or make the same available in hard copy or in any other media without the website owner's express prior written consent. The website owner's copyright must remain on all reproductions of material taken from this website.

**www.next2buy.com**

136/138 station road  
 wallsend, NE28 8QT

**tel: 0191 295 3322**