

**Stamford Avenue  
Springfield  
MK6 3JX**



**Price £240,000**

**NO UPPER CHAIN - A SPACIOUS family home offering great living space and good sized bedrooms. The property is double glazed and has gas radiator heating. Outside is a spacious rear garden and off road parking to the front.**

- Mid Terraced House
- Lounge
- Three Bedrooms
- Front & Rear Gardens
- No Above Chain
- Downstairs Cloakroom
- Kitchen/Diner
- Bathroom
- Off Road Parking To Front

Entrance Hall

Downstairs Cloakroom

Lounge 12'11" (3.94m) x 11'0" (3.35m)

Kitchen/Diner 18'0" (5.49m) x 9'0" (2.74m)

First Floor Landing

Bedroom One 12'0" (3.66m) x 11'0" (3.35m)

Bedroom Two 11'0" (3.35m) x 9'0" (2.74m)

Bedroom Three 10'0" (3.05m) x 6'0" (1.83m)

Bathroom

Front Garden

Rear Garden

Off Road Parking To Front

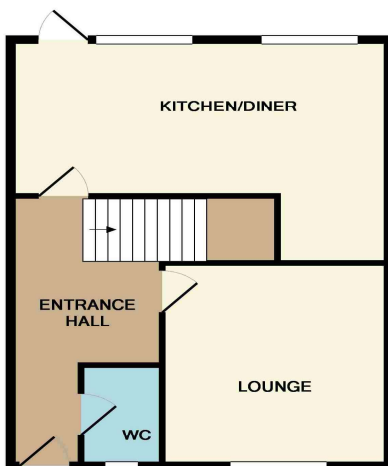

GROUND FLOOR

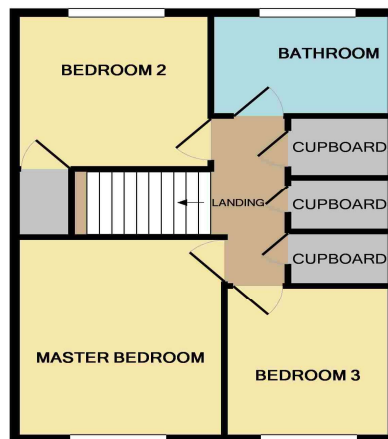

1ST FLOOR

Whilst every attempt has been made to ensure the accuracy of the floor plan contained here, measurements of doors, windows, rooms and any other items are approximate and no responsibility is taken for any error, omission, or mis-statement. This plan is for illustrative purposes only and should be used as such by any prospective purchaser. The services, systems and appliances shown have not been tested and no guarantee as to their operability or efficiency can be given. Made with Metropix ©2019

Energy Efficiency Rating		Current	Potential
Very energy efficient - lower running costs			
(92 Plus)	A		90
(81-91)	B		
(69-80)	C		
(55-68)	D	65	
(39-54)	E		
(21-38)	F		
(1-20)	G		
Not energy efficient - higher running costs			
England & Wales		EU Directive 2002/91/EC	

Environmental Impact (CO <sub>2</sub> ) Rating		Current	Potential
Very environmentally friendly - lower CO <sub>2</sub> emissions			
(92 Plus)	A		91
(81-91)	B		
(69-80)	C		
(55-68)	D	62	
(39-54)	E		
(21-38)	F		
(1-20)	G		
Not environmentally friendly - higher CO <sub>2</sub> emissions			
England & Wales		EU Directive 2002/91/EC	

### Notice

Please note we have not tested any apparatus, fixtures, fittings, or services. Interested parties must undertake their own investigation into the working order of these items. All measurements are approximate and photographs provided for guidance only.

