

The Hide, Netherfield, MK6 4HP

Price £147,995 Leasehold



**NO UPPER CHAIN - REFURBISHED THROUGHOUT.**

Great investment opportunity, all the work has been done and is just ready for someone to move into. Spacious two bedroom first floor maisonette with open plan living area, two good sized bedrooms and a bathroom.



# The Hide, Netherfield, MK6 4HP



Lounge/Kitchen | Inner Hall | Bedroom One |  
Bedroom Two | Bathroom |





Lounge/Kitchen 14'0" (4.27m) x 13'0" (3.96m) Max

Inner Hall

Bedroom One 14'0" (4.27m) x 7'0" (2.13m)

Bedroom Two 10'0" (3.05m) x 7'0" (2.13m)

Bathroom 6'0" (1.83m) x 5'0" (1.52m)



Energy Efficiency Rating		
	Current	Potential
Very energy efficient - lower running costs		
(92 Plus) <b>A</b>		
(81-91) <b>B</b>		
(69-80) <b>C</b>		
(55-68) <b>D</b>		
(39-54) <b>E</b>	42	56
(21-38) <b>F</b>		
(1-20) <b>G</b>		
Not energy efficient - higher running costs		
<b>England &amp; Wales</b>	EU Directive 2002/91/EC	

Environmental Impact (CO <sub>2</sub> ) Rating		
	Current	Potential
Very environmentally friendly - lower CO <sub>2</sub> emissions		
(92 Plus) <b>A</b>		
(81-91) <b>B</b>		
(69-80) <b>C</b>		
(55-68) <b>D</b>		
(39-54) <b>E</b>	52	60
(21-38) <b>F</b>		
(1-20) <b>G</b>		
Not environmentally friendly - higher CO <sub>2</sub> emissions		
<b>England &amp; Wales</b>	EU Directive 2002/91/EC	

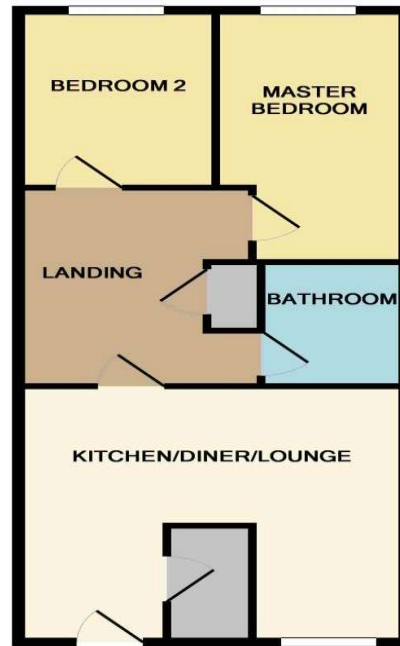

Whilst every attempt has been made to ensure the accuracy of the floor plan contained here, measurements of doors, windows, rooms and any other items are approximate and no responsibility is taken for any error, omission, or mis-statement. This plan is for illustrative purposes only and should be used as such by any prospective purchaser. The services, systems and appliances shown have not been tested and no guarantee as to their operability or efficiency can be given  
Made with Metropix ©2019

*Bletchley /Milton Keynes*

T: 01908 373580

T: 01908 690700

*Leighton Buzzard*

T: 01525 572168

*Rushden*

T: 01933 429929

*Bedford*

T: 01234 941063

E: [info@inspiredagents.co.uk](mailto:info@inspiredagents.co.uk)  
[www.inspiredagents.co.uk](http://www.inspiredagents.co.uk)

## Notice

Please note we have not tested any apparatus, fixtures, fittings, or services. Interested parties must undertake their own investigation into the working order of these items. All measurements are approximate and photographs provided for guidance only.

